

nami Wi-Fi Sensing Plugs

For alarm verification and property awareness

nami Wi-Fi sensing plugs offer whole-home presence detection. Plus, it is the first of its kind to be integrated into the Alarm.com ecosystem.

How Wi-Fi sensing works

- Plugs work together via Wi-Fi to create a Wi-Fi sensing zone
- Motion is detected when the Wi-Fi signal between devices is disrupted
- Wi-Fi motion can validate PIRs and suspected presence in the home

How it's different from traditional PIRs

- Provides broader coverage than PIRs (floor/home) but at lower precision
- Reaches blind spots and rooms not outfitted with security sensors

Wi-Fi sensing for enhanced home awareness

- Wi-Fi motion is included in the customer's in-app Alarm Mode experience to help them make informed decisions about a potential security threat
- Alerts if motion is detected when the customer is away from home



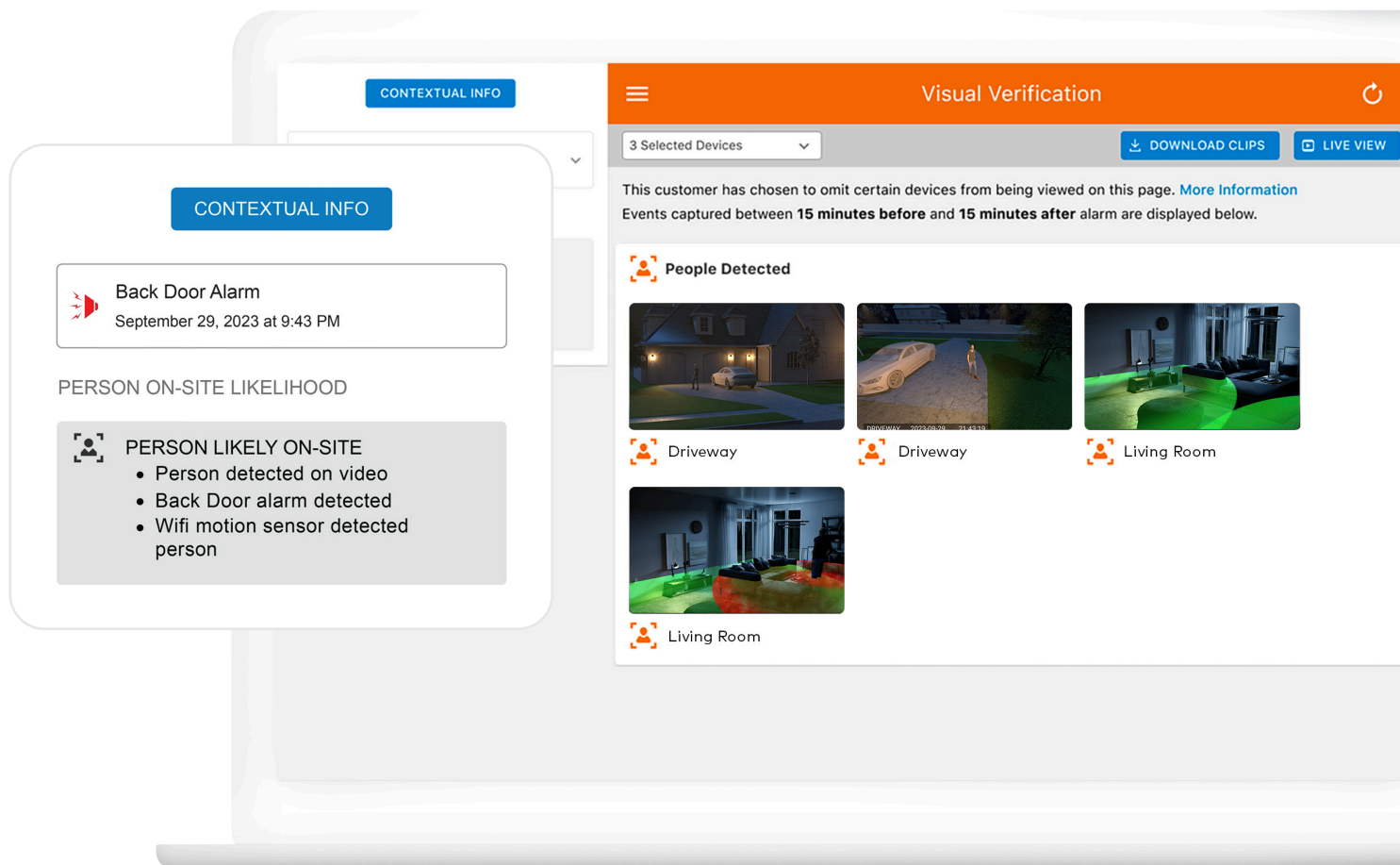

Wi-Fi sensing for Visual Verification

- Wi-Fi motion will not be used to trigger an alarm
- Motion status is displayed as additional information on the Visual Verification portal when an alarm-triggering event occurs (e.g. incorrect code entered at panel or camera detected a person outside a residence)
- Provides extra context for Central Monitoring Station operators to assess situations more accurately

Specifications

- Each kit comes with three plugs that form a Wi-Fi sensing zone, covering approximately 1,000 sq. ft (100 sq. m)
- Works best for individuals with:
 - + Single-family homes
 - + Pets under 50 lbs

Standard plug functionality

- Provides standard plug functionality and can be remotely controlled via the Alarm.com mobile app
- Easy automation with rules, schedules, and Scenes